

⚠ IMPORTANT.

For your safety, this screw is designed to allow the half chin bar to breakaway in an emergency.

This screw is specially designed to breakaway in case of an emergency. The Half Chin Bar can be completely separated from the helmet to allow access to the driver's facial area in an emergency situation.

To allow access, pull the Half Chin Bar outward with sufficient force, allowing the Soft Safety Screw to break. The Half Chin Bar can then be removed in order to allow better access to the driver's airway in an emergency.

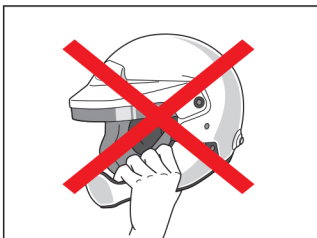

Don't take the helmet by the Half Chin Bar

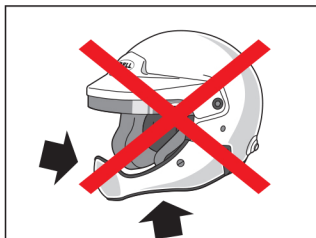

Don't hit or press the Half Chin Bar

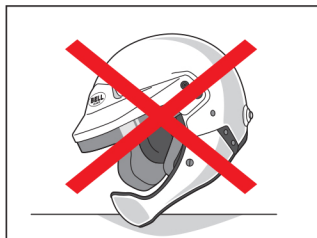

Don't drop or lean on the Half Chin Bar

www.bellracing.com



SERIOUS HEAD PROTECTION

HALF CHIN BAR

⚠ IMPORTANT.

Read this notice before assembling or disassembling the HALF CHIN BAR.

Bell has designed an innovative, patented half chin bar with an anechoic chamber and integrated microphone to improve driver communications and reduce disturbances from environmental and road surface noise common with rally racing. The Bell half chin bar incorporates acoustic dissipating elements to dampen the sound energy associated with acoustic waves reducing noise and echoes that interfere with communications, optimizing acoustical clarity.

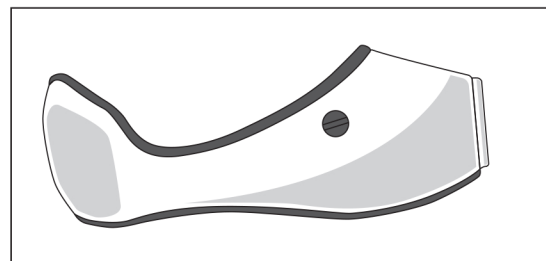

- The half chin bar is fully compliant with Snell and FIA homologation requirements and can be easily removed for access to the driver in an emergency.
- Versions of the Bell half chin bar are compatible with Bell rally helmets including the HP9 Rally, Mag-9 Rally Carbon and Mag-9 Rally.

www.bellracing.com

CORRECT ASSEMBLING

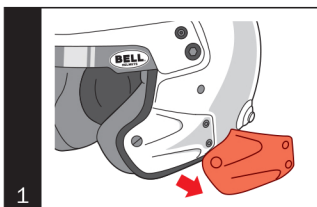

1 Remove the screws and remove the side cover if your helmet has it.

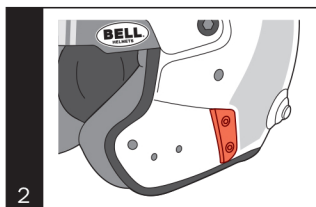

2 Apply the hinge with the two metal screws.

⚠ IMPORTANT.

Insert the screws without fully tightening them to be able to place the Half Chin Bar in position.

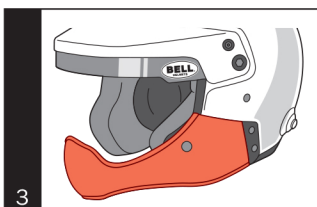

3 Apply the Half Chinbar under the hinge with the soft safety screw. Make sure the hole in the helmet is aligned with the hole in the Half chin Bar.

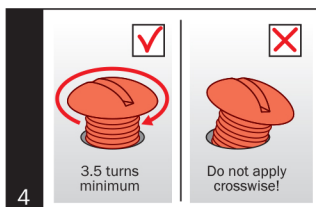

4 Thread the soft safety screw into the insert straight with a minimum of 3.5 turns.

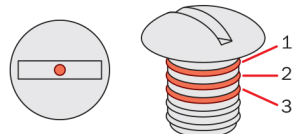

⚠ IMPORTANT.

Only use the safety screw with the special mark in the center (included). When installed correctly it is possible to see a minimum of 3 threads at the top of the screw.

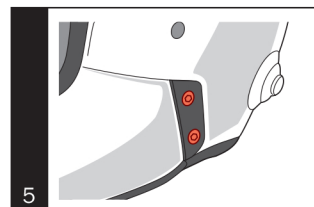

5 Tighten the screws of the hinge.

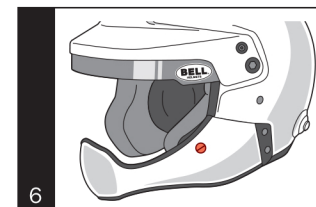

6 Finish tightening the safety screw until the Half Chin Bar is adjusted to the helmet.

⚠ IMPORTANT.

Do not over tighten the safety screw. Stop tightening the screw when the Half Chin Bar is properly fixed to the helmet. Over tightening the screw can damage it and affect its safety function.

CORRECT DISASSEMBLING

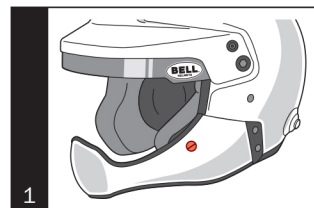

1 Remove the soft safety screw.

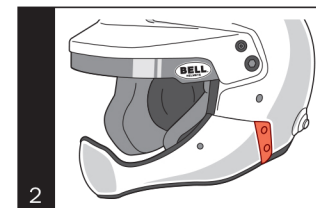

2 Remove the screws and remove the hinge.

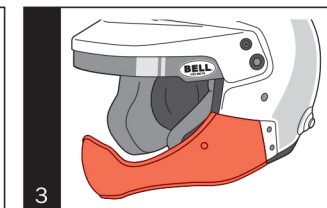

3 Remove the Half Chin Bar.